

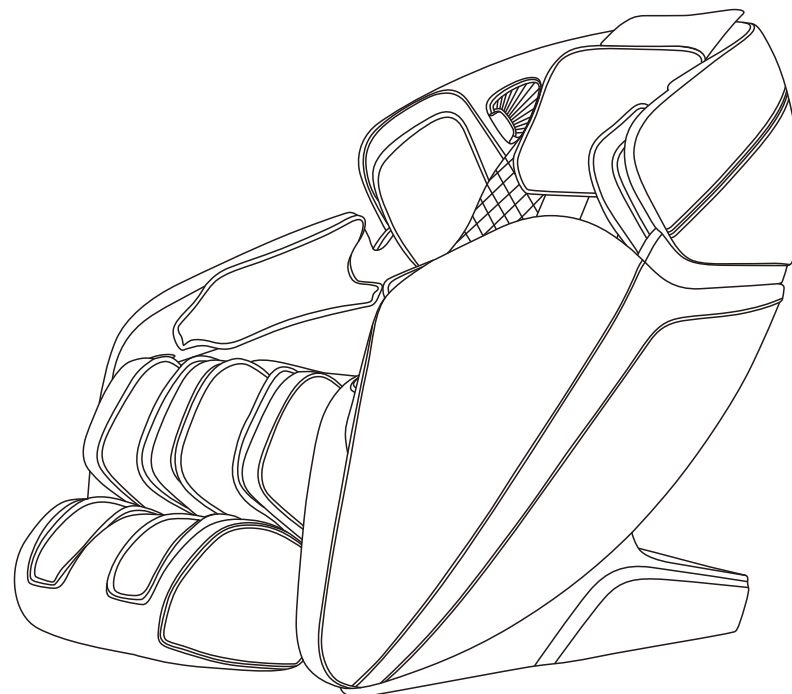

ICOMFORT PLUS MASSAGE CHAIR

OPERATION INSTRUCTIONS

SAVE THESE INSTRUCTIONS



Thank you for purchasing this product. Before you use it, please read the Operation Instructions in detail for the correct usage of this product, especially the important safety warnings. Keep the Operation Instructions properly for future reference.

Note: Our company reserves the right to change and explain any product design without prior notice. Product colors are subject to the actual products.

TABLE OF CONTENTS

Safety and Maintenance	02-03
Safety Warning	04-05
Name of Components	06
Function	07
Introduction to the Remote Controller	09-10
Method of Usage	10-36
I.Turn on the power supply of this product	10
II.Massage Function Control Operation	10-27
III.Introduction to Armrest Shortcut Keys	28
IV.Voice Control Instruction	29
V.Turn off the power and stop massage	30
VI.Operation Instructions for Bluetooth Speaker Play	30
VII.Installation Instructions for Legrest	30
VIII.Instructions for Removal and Use of Head Cushion and Backrest	31
IX.Floor Protection	32
X. Instruction for Movement	32
Product Specification	33

Safety and Maintenance

1. Important Safety Warnings

- Do not allow children to touch any movable part of this product.
- Use the well-grounded power supply unit suitable for this product.
- Pull out the plug after use or before cleaning to avoid any physical injury or damage to the product.
- Operate this product as instructed in this manual.
- Do not use any parts or accessories which are not recommended.
- Do not use this product outdoors.
- Please read the Operation Instructions carefully before operation.
- Never use this product for any other purpose not listed herein.
- 20 minutes of usage each time is recommended.
- Do not use this product if the leather is broken or damaged.
- Do not use this product if the cover or leather is broken or damaged.
- Do not use this product if the radiator hole is covered or blocked.
- Do not drop anything into this product.
- Never fall asleep while using this product.
- Do not use this product if you are drunk or feel unwell.
- Do not use this product within one hour after a meal.
- Do not use this product with excessive force to avoid any injury.
- Do not carry any fragile, explosive, or combustible material in your pocket, such as a mobile phone and lighter when using the massage chair.

2. Operating Environment

- Do not use this product in a very moist environment such as the bathroom.
- Stop using this product immediately when the ambient temperature changes sharply.
- Do not use this product in any heavily-dusty or caustic environment.
- Do not use this product in a small space or a place without good ventilation.
- The normal room temperature ranges from 0 °C to 35 °C.
- Do not use this product in an excessively humid room such as a bathroom. Use it at a relative humidity between 20% and 80%.
- Do not use this product outdoors.
- Avoid direct sunlight.
- Keep this product away from any heat source such as a stove and air outlet of an air conditioner.
- Do not use this product during thunder or lightning weather.
- Do not use this product in dusty places.

3. The following populations should not use this product

- Patients with osteoporosis.
- Patients with heart disease or wearing electronic medical devices such as a pacemaker.
- People who have a fever.
- Pregnant women or women on their menstrual period.
- Patients who are injured or have a skin disease.
- When unsupervised, any children are under the age of 14 and those unconscious are not allowed to use this product.
- People who are told by their physicians to have rest or who feel unwell.
- People whose bodies are wet are forbidden to use this product.
- This product has a hot surface. Persons insensitive to heat must pay attention when using this product.

Safety and Maintenance

4. Safety Precautions

- Check whether voltage is consistent with the specification of this product.
- Never insert or pull out the plug with a wet hand.
- Do not let water flow into this product to avoid electric shock or cause damage to this product.
- Do not pull the power cord when plugging or unplugging it. Rough handling is forbidden.
- Do not damage the wire or modify the circuit of this product.
- Do not clean live parts of this product with a wet cloth such as a power switch and plug.
- Be away from this product in case of power failure to avoid any injury if power is restored suddenly.
- Stop using this product at once while it works abnormal, and consult your local supplier.
- Stop using this product if you feel unwell, and consult your health care practitioner.
- This product is not intended for use by persons (including children) with reduced physical, sensory or mental capabilities, or lack of experience and knowledge, unless they have been given supervision or instruction concerning the use of this product by the personnel responsible for their safety. Children should be supervised to ensure that they do not play with this product.
- If the power cord is damaged, it must be replaced by the manufacturer, its service agent or similarly qualified staff in order to avoid hazards.

5. Product Service and Maintenance

- This product should be maintained by the service center designated by the manufacturer only. No user should disassemble or maintain it without permission.
- Do not forget to turn off the main power switch after usage.
- Do not use this product if the power socket becomes loose.
- If this product will be left unused for a long period of time, it is necessary to roll up the power cord of this product and store this product in a dry and dust-free environment.
- Do not store this product at a high temperature or near open flame. Avoid prolonged exposure to direct sunshine.
- Please clean this product with dry cloth. Never use thinner, benzene or alcohol.
- The mechanical components of this product are specially designed and manufactured, so no special maintenance is needed.
- Do not use a sharp object to stab at this product.
- Do not roll or pull this product on any uneven ground. Instead, it should be lifted before moving.
- Please use this product intermittently. Do not keep it working continuously for a long period of time.

6. Solutions to Ordinary Malfunctions

- If the motor sounds during operation of this product, this is the normal operation sound.
- If the controller cannot work normally, check whether the plug and the power socket are connected reliably, and whether the power switch is turned on.
- If the rated working time is over, this product will automatically activate the power-off button; If this product keeps operating for a long period of time, the temperature protector will stop this product automatically. The product can be used again after half an hour.

7. Storage Conditions

- Storage room temperature: -5 °C to 35 °C.
- Relative humidity (RH) between 20% and 80%; free of corrosive gases, and a well-ventilated room.

Safety Warning

! Warning

When the legrest of the massage chair is lifted, nobody should apply pressure on the legrest to prevent the massage chair from falling forward which will damage this product or result in personal injuries.

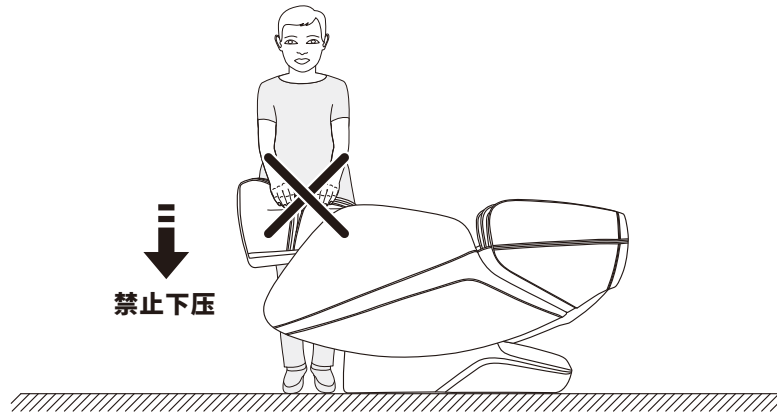

! Warning

Before sitting on the massage chair, make sure that the massage chair manipulator does not stay in the seat cushion position to avoid discomfort to the buttocks during the body pressing down and any damage to the massage chair manipulator.

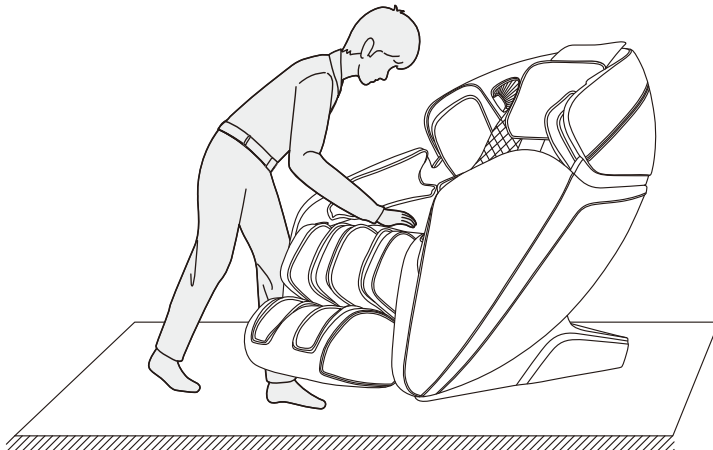

Safety Warning

! Warning

Do not remove or pull out the remote controller cable or the power cord in the standby or power-on state to avoid any damage to this product or accidental electric shock of a body part. You are advised to unplug the remote controller cable and the power cord and put them away after you use the massage chair.

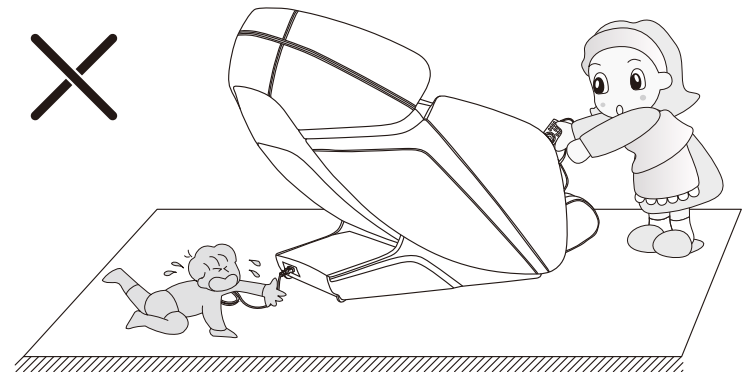

! Warning

When the zero-gravity lying function is enabled, be sure to check whether there is any child or pet staying or playing under the bottom of the legrest and backrest, in order to avoid any damage to this product or physical injury.

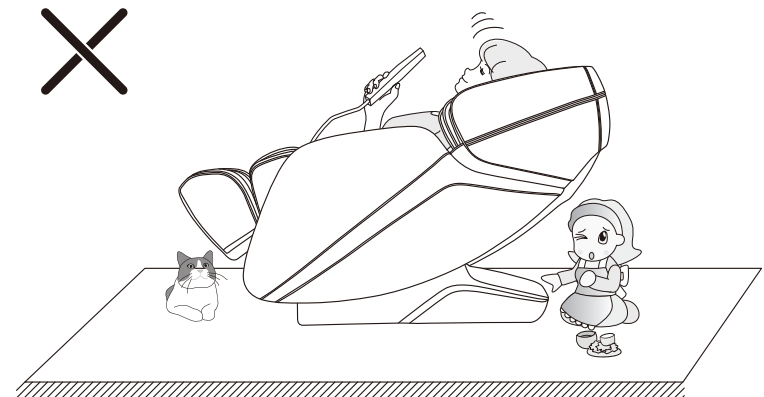

Name of Components

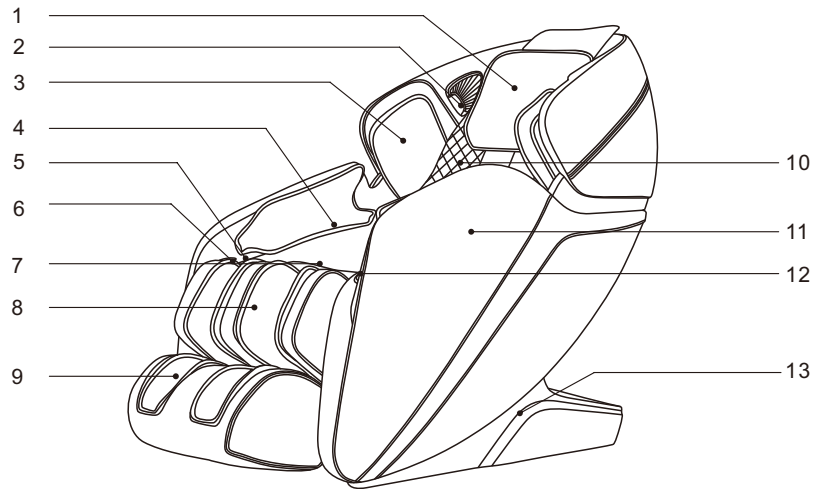

- 1.Head pillow
- 2.3D digital speaker
(left side with voice
control device)
- 3.Shoulder airbag parts
- 4.Arm airbag parts
- 5.Pocket for remote control
or mobile phone
- 6.USB charger
- 7.Seat
- 8.Calf part
- 9.Foot part
- 10.Back part
- 11.Armrest
- 12.Handrail shortcut key
- 13.Side cover

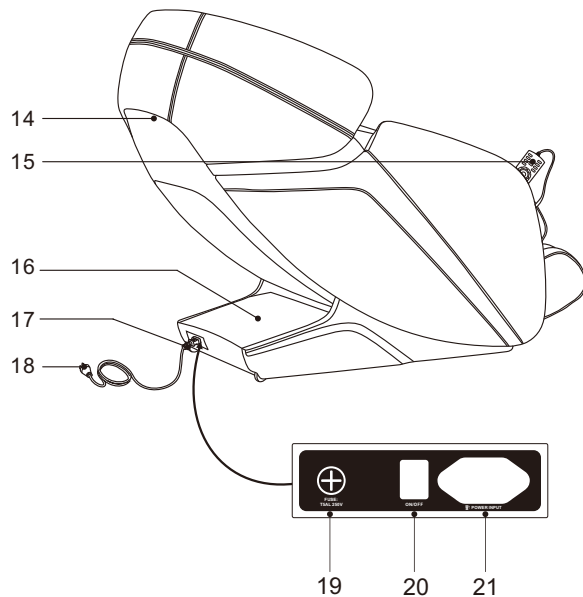

Function

- This product has designed a set of massage manipulator that can walk up and down, four-wheel drive and mute design.
- There are five simulated massage techniques: finger pressing, kneading, tapping, tapping and kneading at same time.
- Equipped with shoulder automatic positioning detection.
- Automatic massage functions: automatic massage includes 8 kinds of automatic massage functions, including comfortable massage, relaxing massage, stretch massage, shoulder and neck massage, back and waist massage, whole body massage, fast massage ,spinal massage.
- With two memory function : iMenory 1, iMenory 2.
- Equipped with upper body manual massage function (the whole body, fixed point and local, upper back ,lower back ,totally five massage parts are selected, and the speed of each massage manipulation can be adjusted with five speed. In fixed point and local state, the manipulator can adjust the position up and down; When tapping, pressing and percussion massage, the width of the massage ball can be wide, medium or narrow.
- Air pressure function : shoulder airbag massage (totally 4 airbags) ,armrest airbag massage (totally 8 airbags), foot airbag massage (totally 12 airbags), there level intensity adjustable.
- Zero wall design for save the room space.
- Backrest frame guide adopts curve guide technology, which completely conforms to the curve of human back, and can enjoy massage from head to thigh.
- Music playback system, 3D digital audio built into left and right shoulder. Use the Bluetooth function of the smart device to play music wireless.
- Equipped with intelligent voice control recognition function.,left armrest with voice control wake up button , voice control can be optional stop or start.
- In the left and right palm air bags, there is a salient massage with a magnetic massage function.
- Calf rest lifting or recline adjustment, lifting or recline adjustment of leg and back, zero gravity I or zero gravity II and time setting adjustment function.
- At the bottom of foot have roller massage function, three pairs of rollers massage on toe root; scraping massage function on the arch and heel.
- At the calf have kneading massage function which can relieve the stiffness and stress of calf.
- Back heat , adopt with Carbon fiber far infrared heating.
- Left armrest with button : on/off button, footrest lifting&lying button, Auto mode button, voice control wake up button.
- The right handrail is equipped with USB charging function.
- TFT Color screen controller.
- Shutdown automatic sitting function, manipulator automatic reset function. •

Introduction to the Remote Controller

Remote Controller Interface

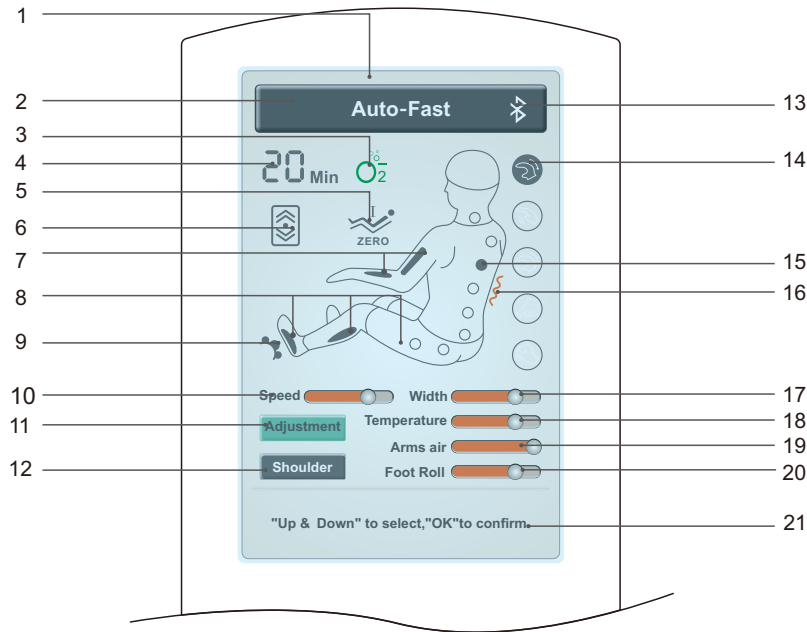

Note: The remote controller displays the colors, massage function messages and massage function icon layout order. Please refer to the physical display!

- | | |
|-----------------------------------------------|-----------------------------------------------|
| 1. TFT color LCD | 12. Shoulder position adjustment |
| 2. Message function status bar | 13. Bluetooth display |
| 3. Anion generator display | 14. Massage mode display |
| 4. Time display | 15. Massage position display |
| 5. Zero gravity display | 16. Back heat treatment display |
| 6. Back stretching display | 17. Width adjustment |
| 7. Air pressure display for the arms | 18. Temperature adjustment for heat treatment |
| 8. Air pressure display for the legs and feet | 19. Air pressure adjustment |
| 9. Foot roller display | 20. Roller adjustment |
| 10. Speed adjustment | 21. Information bar |
| 11. Adjustment | |

Introduction to the Remote Controller

Remote Controller Buttons

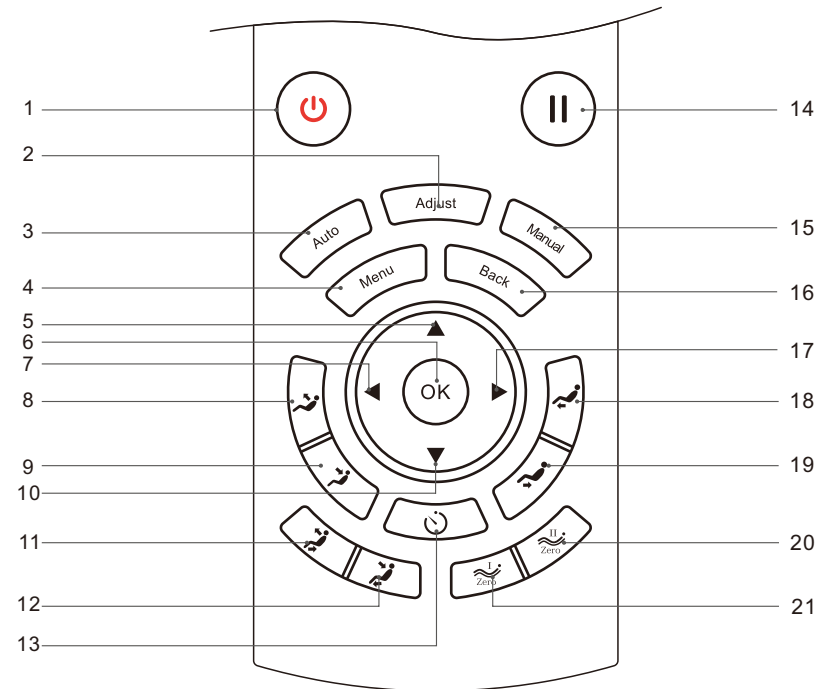

- | | |
|--------------------------------------------------------------|---------------------------------------------------------------------|
| 1. On/off: start or close massage chair | 12. Backrest & footrest lying: chair lying down |
| 2. Adjustment: enter to the interface to adjust the function | 13. Time setting: adjust the working time |
| 3. Auto: enter to the interface to choose auto program | 14. Pause button: Pause the massage |
| 4. Menu: enter to the interface of main menu | 15. Manual program: enter to the interface to choose manual program |
| 5. Up: go up | 16. Back: go back to Massage working interface |
| 6. Ok: confirm | 17. Right: go right |
| 7. Left: go left | 18. Footrest lifting: adjust the footrest lifting angle |
| 8. Backrest lifting: adjust the backrest lifting angle | 19. Footrest lying: adjust the footrest lying angle |
| 9. Backrest lying: adjust the backrest lying angle | 20. Zero gravity I: adjust the Zero gravity I |
| 10. Down: go do | 21. Zero gravity II: adjust the Zero gravity II |
| 11. Backrest & footrest lifting: chair seat up | |

Method of Usage

I. Turn on the power supply of this product

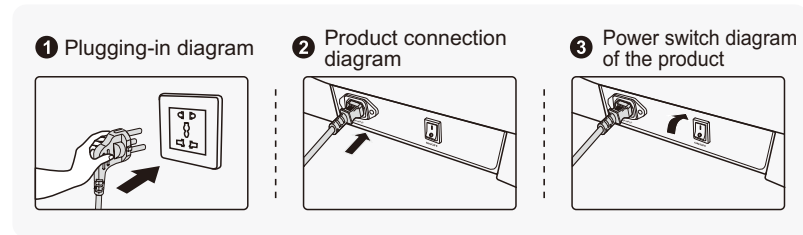

II. Massage Function Control Operation

1. Standby

- After the massage chair is powered on or turned off or when it is in standby mode, it cannot enter any mode of operation, except the settings.



2. Start massage (power switch)

- Press the power button to start massage. The backrest and legrest will automatically lie down based on the preset angles.
- After automatically lying down, the massage chair will automatically detect the shoulder position and body shape. Wait until the detection is completed. Alternatively, press "OK" to skip such detection. The default value will be adopted automatically to start massage.

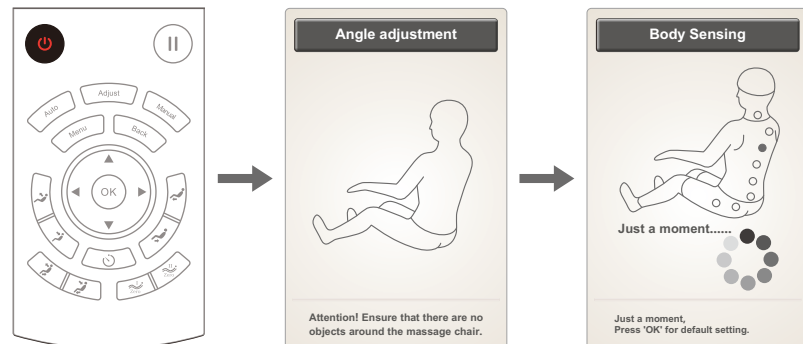

Method of Usage

- After detecting the shoulder position, the buzzer will beep. If there is any difference from the actual shoulder position, adjust it to the appropriate position by pressing the "UP" or "DOWN" key. The shoulder position has 11 adjustable levels. If there is no shoulder position adjustment within 10 seconds, the massage function will start automatically. Alternatively, press "OK" directly to start massage immediately. If no shoulder position can be detected, massage will be started according to the shoulder height by default.

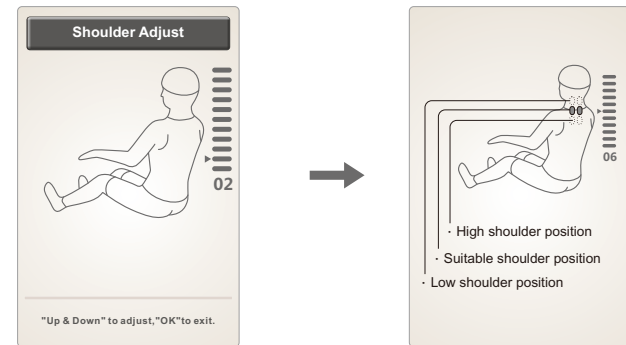

Button	Description
	Move the massage balls upward to a suitable shoulder position.
	Move the massage balls downward to a suitable shoulder position.

- In the current interface, you can use the navigation keys to go up and down to select the "Adjustment" button or "Shoulder Position". After selecting the function to be set, press "OK" to enter.

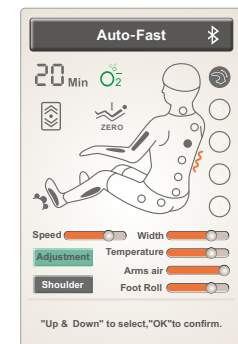

Method of Usage

3.Pause button

- While the message function is running, press the "Pause" button to temporarily stop all the message functions; press the "Pause" button again to continue the message function before pause. If the pause time exceeds 20 minutes, all the message functions will be automatically turned off.

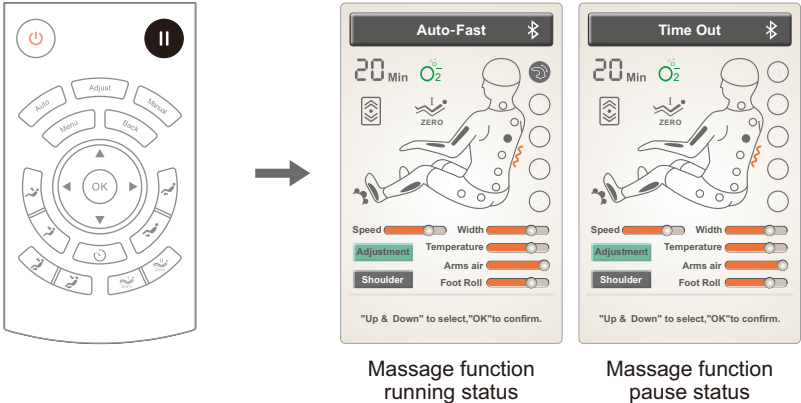

4.Menu

- Press the "Menu" button to enter the main menu message function selection interface, including: automatic function, manual mode, adjustment, customize, settings, and equipment information function interface.
- Press the "UP/DOWN" button to choose the message function. Press "OK" to confirm that you have entered the message function menu selected. Press the "Back" button to return to the selected function operation status information interface.

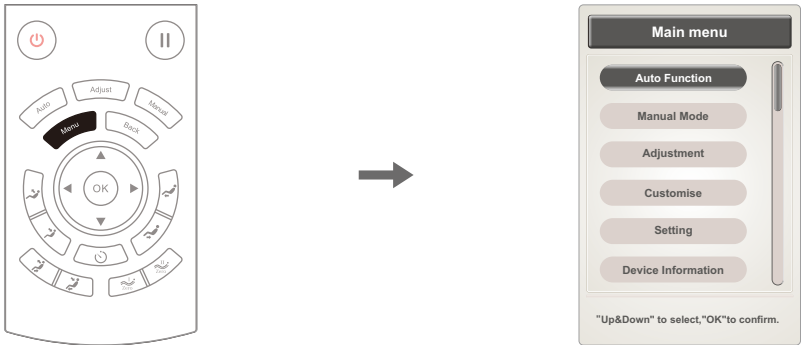

5Automatic function (AUTO key: You can also press the "AUTO" key directly to enter the automatic function interface.)

Method of Usage

- Press the "Menu" button to enter the main menu interface, and select the automatic function icon: The automatic mode consists of fast message, comfortable message, relaxing message, stretching message, full body message, chiropractic message, neck & shoulder massage, and back & waist massage modes.
- Press the "UP/DOWN" button to choose the message function. Press "OK" to confirm that you have entered the message function menu selected. Press the "Back" button to return to the selected function operation status information interface.

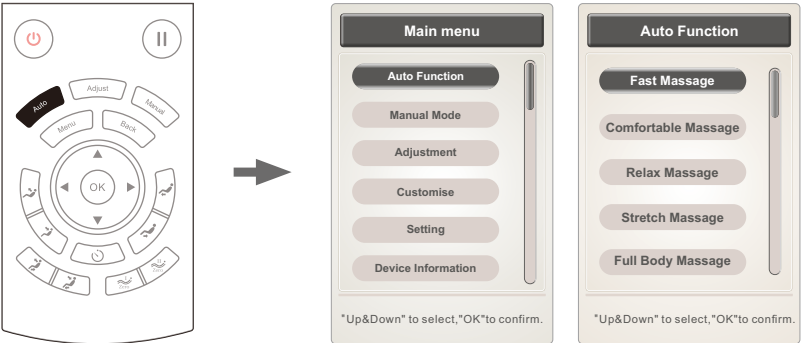

Function	Description
Fast message	Experience all the massage effects quickly.
Comfort message	The most comfortable massage experience.
Relax message	Gentle and comfortable deep massage to relieve your body fatigue and relax the body.
Stretch message	Stretch your legs and waist through the legrest and the backrest to effectively remove fatigue, relieve joint pain and restore vitality.
Full body message	Deep massage to rejuvenate your body.
Spinal message	Focus on chiropractic massage, and relax your body and mind.
Neck& shoulder message	With the unique massage technique for the neck and shoulder, the effective massage for the cervical spine and scapula can be performed to relieve the neck and shoulder pain and reduce fatigue on the neck and shoulder.
Back&waist message	Focus on the back and waist massage to relieve the pain on the back and waist.

Note: The automatic function already selected will be displayed in the message function status bar. You can directly press the "Back" button to view the running status.

Method of Usage

6.Manual mode (Manual button: You can also press the "Manual" button directly to enter the manual mode interface.)

- Press the "Menu" button to enter the main menu interface, and select the manual mode icon: including massage technique, massage part, airbag massage, and other massage functions.
- Press the "Left" or "Right" button to switch among the submenus. Then press the "UP" or "DOWN" button to select the massage function. Press the "Back" button to return to the running status information interface.

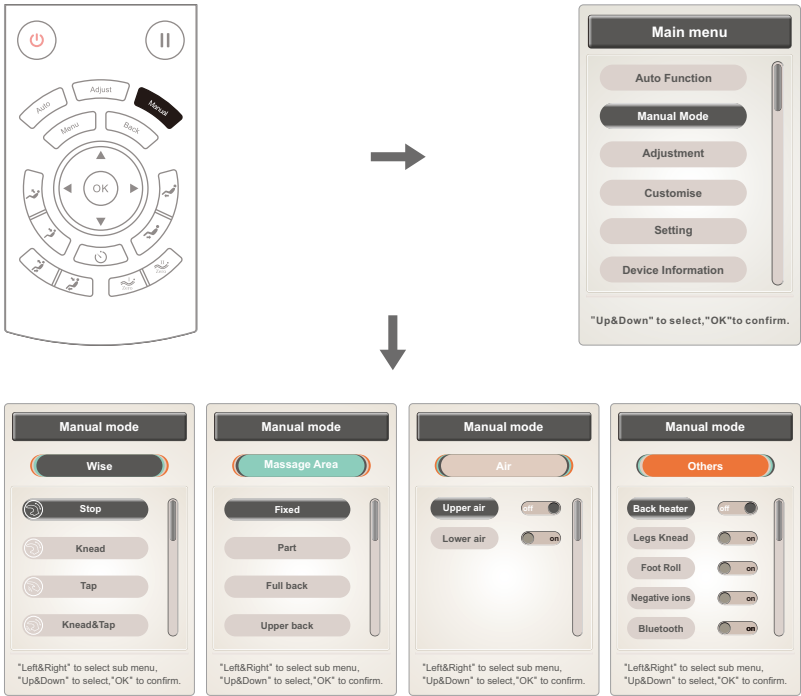

01)Manual mode (manual button-massage mode)

- Manual mode (massage techniques): including five different massage techniques, such as kneading, tapping, simultaneous kneading and tapping, shiatsu, and knocking. In the massage state of tapping, shiatsu and knocking, the massage ball width is adjustable.
- Press the "UP/DOWN" button to select the massage technique icon. Then press "OK" to confirm that the massage technique will be applied.

Method of Usage

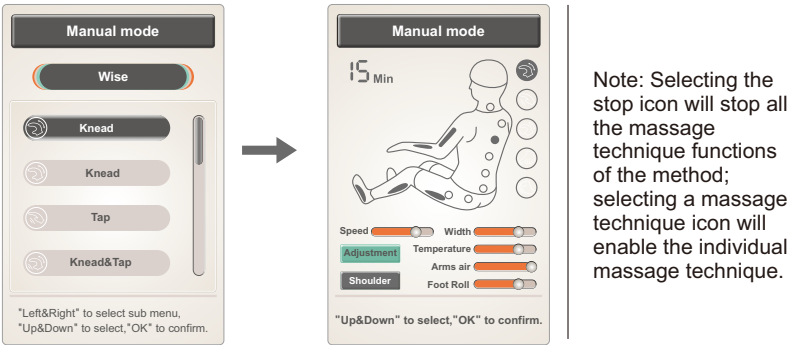

Note: Selecting the stop icon will stop all the massage technique functions of the method; selecting a massage technique icon will enable the individual massage technique.

Function		Description
Kneading	Speed	• 5 speed levels adjustable
Tapping	Speed, width	
Simultaneous kneading and tapping	Speed	
Shiatsu	Speed, width	• 3 width levels adjustable
Knocking	Speed, width	

02). Manual mode (manual button - massage area)

- Manual mode (massage area): including such massage functions as fixed point, local, full back, upper back, and lower back.
- Press the "UP/DOWN" button to select the area function icon. Then press "OK" to confirm the area selected.

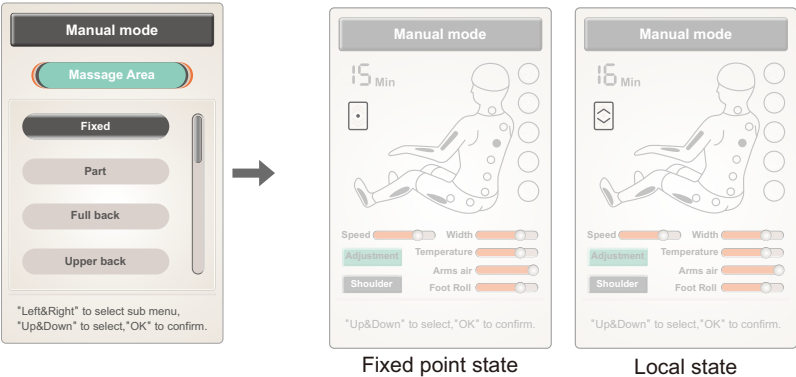

Method of Usage

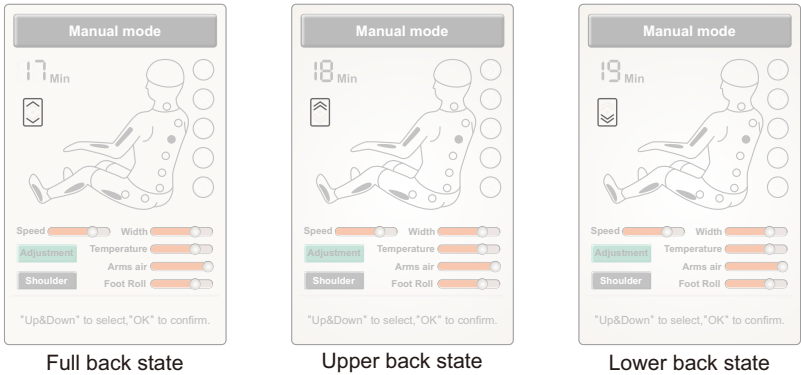

Function	Description	
Fixed point	Massage at fixed point	When choosing the fixed point and local massage technique, you can adjust the massage area by pressing the "UP/DOWN" button.
Local	Local round-trip massage in a small area	
Upper back	Round trip massage on the upper back	
Lower back	Round trip massage on the lower back	
Full back	Round trip massage on the full back	

03).Manual mode (manual button - airbag massage)

- Manual mode (airbag massage): including airbag massage functions for the upper body and the lower body.
- Press the "UP/DOWN" button to choose different airbag massage functions. Press "OK" to confirm your choice.

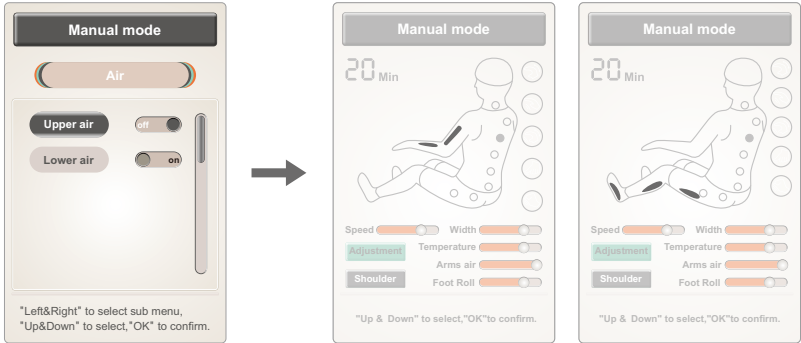

Method of Usage

Function	Description
Airbag massage for the upper body	Enable or disable the airbag massage function for the upper body
Airbag massage for the lower body	Enable or disable the airbag massage function for the lower body

04).Manual mode (manual button - others)

- Manual mode (other massage functions): including such massage functions as heat treatment on the back, leg kneading, foot roller, anion generator, and Bluetooth.
- Press the "UP/DOWN" button to choose the massage function. Press "OK" to enable or disable such massage function.

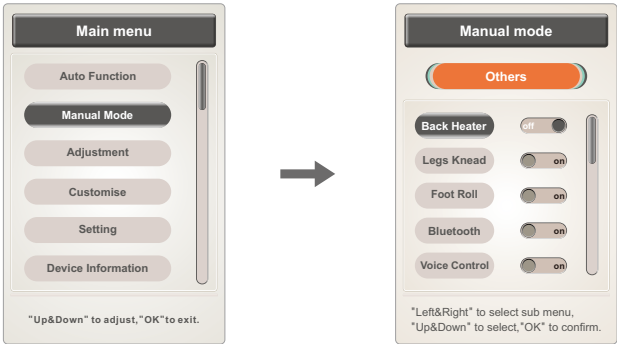

• Manual mode (others - back heat)

- Click "OK" to enable or disable the back heat treatment function; this is the far infrared heating function, and the back will become warmer after such heating for 3min.
- Press the "UP" or "DOWN" button to select other massage functions. Press the "Back" button to return to the running status information interface.

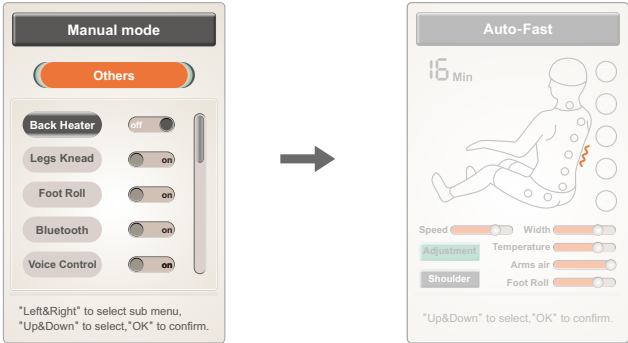

Method of Usage

• Manual mode (others - legs knead)

- Press "OK" to enable or disable the leg kneading massage function.
- Press the "UP" or "DOWN" button to select other massage functions. Press the "Back" button to return to the running status information interface.

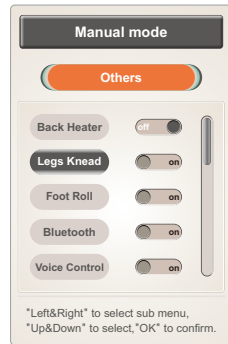

• Manual mode (others - foot roll)

- Press "OK" to enable or disable the foot roller massage function.
- Press the "UP" or "DOWN" button to select other massage functions. Press the "Back" button to return to the running status information interface.

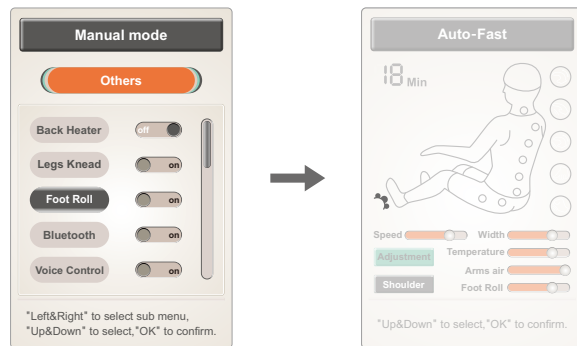

Method of Usage

• Manual mode (other - Bluetooth)

- Press "OK" to enable or disable the Bluetooth function.
- After a Bluetooth-enabled audio source device (e.g. mobile phone, MID tablet) is connected with the Bluetooth module of the massage chair, the music played by the audio source device can be wirelessly transmitted to the audio system of the massage chair via Bluetooth for music playback.
- Press the "UP" or "DOWN" button to select other massage functions. Press the "Back" button to return to the running status information interface.

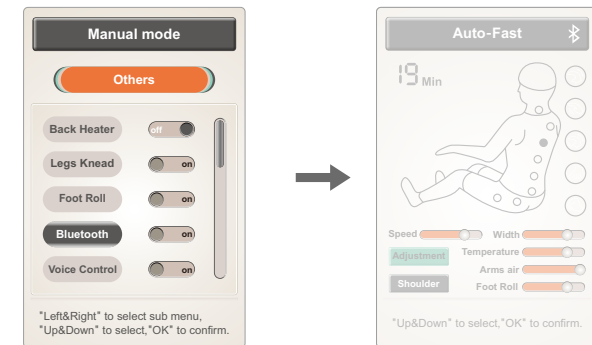

• Manual Mode (others --voice control)

- Press" ok "button to start or close the voice control.
- Press "up" or "down" button to choose other function . Press" back " to back to status information interface.

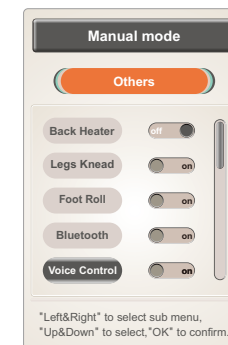

Method of Usage

7. Adjustment function (Adjustment button: You can also press the "Adjustment" button directly to enter the adjustment function interface.)

- Press the "Menu" button to enter the main menu interface, and select the adjustment function icon: including such message functions as message technique, message area, and message intensity (only timing available now).
- Press the "Left" or "Right" button to switch among the submenus. Select the message function in the menu. Then press the "UP" or "DOWN" button to select the message function to be adjusted. Press "OK" to confirm your choice, or press the "Back" button to return to the running status information interface.

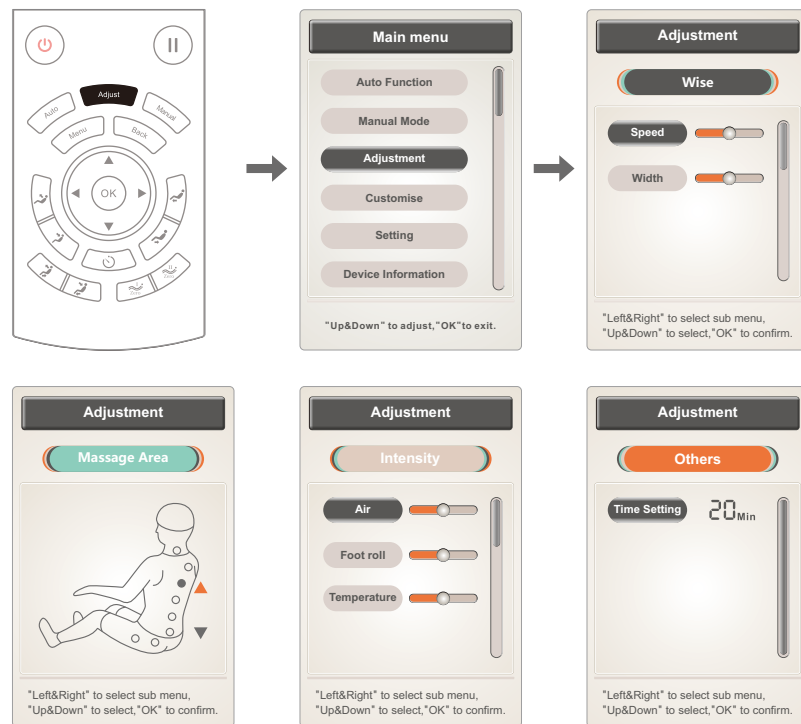

01).Adjustment function (adjustment button - massage techniques)

- Adjustment function (massage techniques): the message technique adjustment function is for the adjustment of message speed and message functions.
- Press the "UP" or "DOWN" button to select the speed or width function. Then press "OK" to adjust the speed and width.

Method of Usage

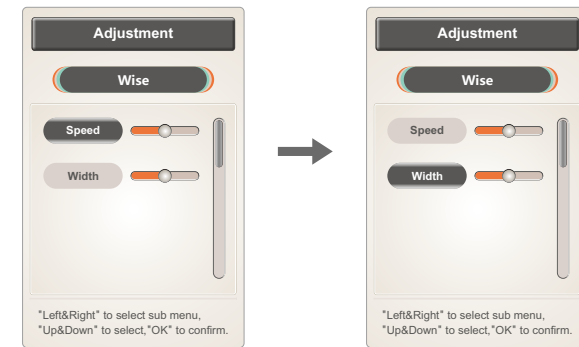

Note:

- Speed: The message speed of manipulators is adjustable; there are 5 speed levels.
- Width: In the message state of tapping, shiatsu and knocking, there are three width levels for switching.

02).Adjustment function (adjustment button - message area)

- Adjustment function (message area): In the fixed point or local message area state, such manipulator will move upward if you hold down the "UP" button; after you release it, such movement will stop. Such manipulator will move downward if you hold down the "DOWN" button; after you release it, such movement will stop. Press the "UP" or "DOWN" button to select the message area for adjustment.

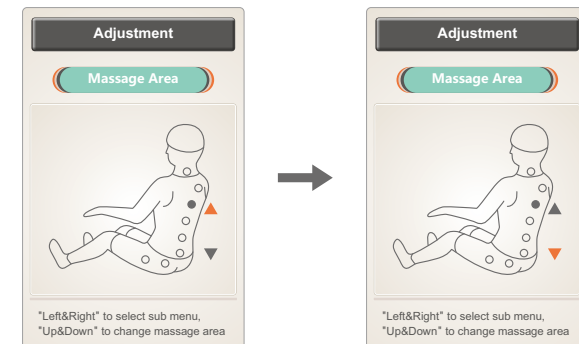

03). Adjustment function (adjustment button - message intensity)

- Adjustment function (message intensity): including such message functions as airbag message and roller; there are 5 levels of intensity for switching. For the temperature adjustment for heat treatment, there are 3 temperature levels.
- Press the "UP" or "DOWN" button to select the air pressure intensity or the roller message intensity. Then press "OK" to confirm such intensity.

Method of Usage

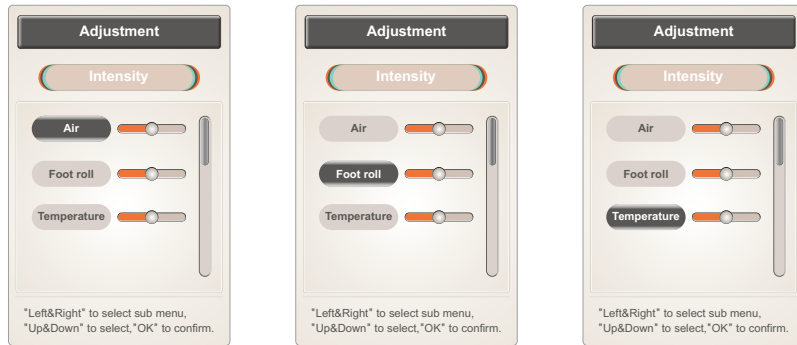

04).Adjustment function (adjustment button - other adjustments)

- Adjustment function (other adjustments): only timing available now. When "OK" is pressed every time, the duration will increase by 5 minutes; if it exceeds 40min, 40min will be reduced.
- Press "OK" for time adjustment (when "OK" is pressed every time, the duration will increase by 5 minutes; the minimum duration is 5min, and the maximum duration is 40min). Press the "Back" button to return to the running status information interface

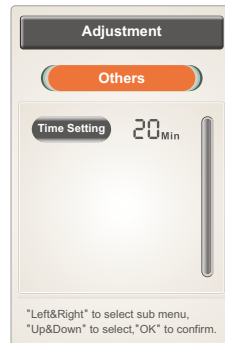

8.Customize

- Press the "Menu" button to select "Customize" in the main menu. Then enter the "Intelligent Custom Memory" interface to select a specific interface, including: Intelligent Custom Memory I & II, and other storage or call function.
- Press the "Left" or "Right" button to select the storage or call function. Then press "OK" to confirm your choice.
- Press the "UP" or "DOWN" key to select Intelligent Custom Memory I or Intelligent Custom Memory II.
- Storage: Store the massage mode, massage technique, airbag massage mode and intensity under the current running status, the position and angle of the legrest and the backrest, and other massage functions.
- Call: Call the massage mode, massage technique, airbag massage mode and intensity, the position and angle of the legrest and the backrest, and other massage functions previously stored.
- Press the "Back" button to return to the running status information interface.

Method of Usage

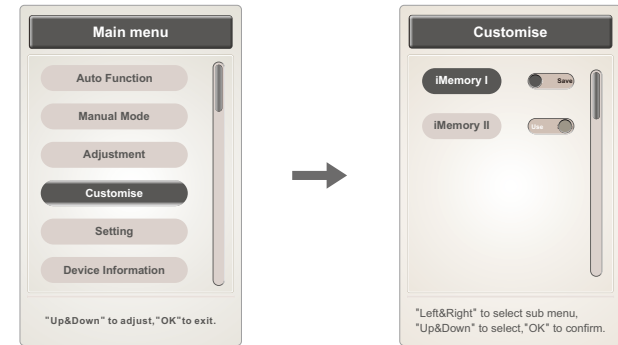

9.Setting

- Press the "Menu" button to enter the main menu interface. Select the "Settings" function icon to enter the setting interface for language, backlight, auto-lock and other settings.
- Press the "Left" or "Right" button to switch among the submenus. Press the "UP" or "DOWN" button for function selection. Press the "Back" button to return to the running status information interface.

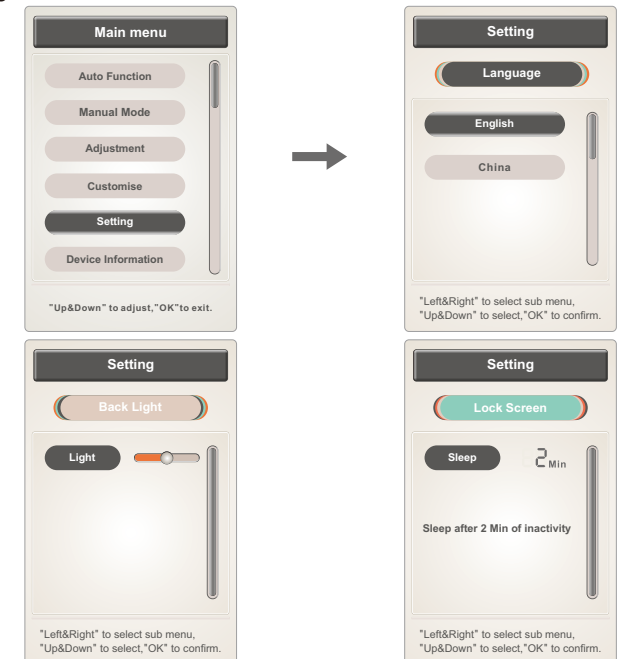

Method of Usage

01).Setting (language)

- Settings (language): Select Chinese or English.
- Press the "UP" or "DOWN" button to select the language type. Press "OK" to confirm your choice. Then press the "Back" button to return to the running status information interface.

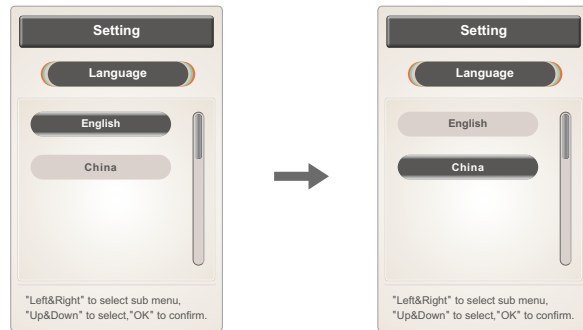

02).Setting (auto-lock)

- Settings (auto-lock): Press "OK" to adjust the auto-lock duration. There are six options for the auto-lock duration: 15 sec, 30 sec, 1min, 2min, 3min, or never. Press "OK" for adjustment; or press the "Back" button to return to the running status information interface.

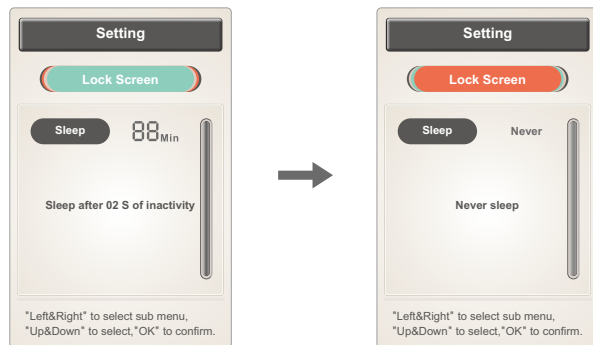

Method of Usage

03).Setting (backlight)

- Set the (backlight) brightness. Press "OK" to adjust the brightness. There are 5 brightness levels for your option. Press the "Back" button to return to the running status information interface.



10.Device information

- Press the "Menu" button to enter the main menu interface and select the equipment information function. The information such as the model of the current equipment will be displayed.
- Press the "UP/DOWN" button for selection. Then press "OK" to confirm your choice. Press the "Back" button to return to the running status information interface.

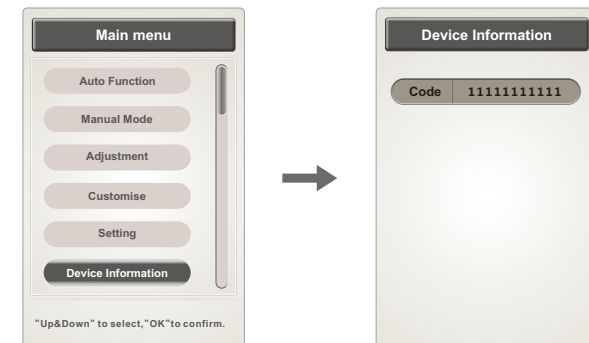

Method of Usage

11.Zero gravity key

· Press the "Zero Gravity" key to enable the zero gravity adjustment function. Upon your request, you can select the position for "Zero Gravity I" or "Zero Gravity II".

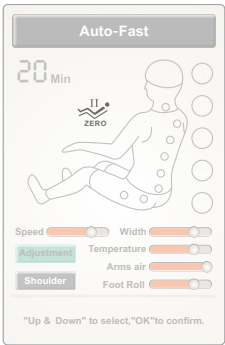
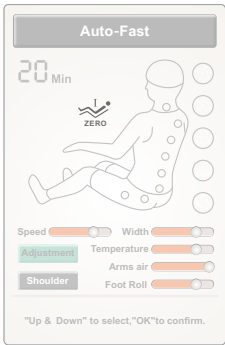
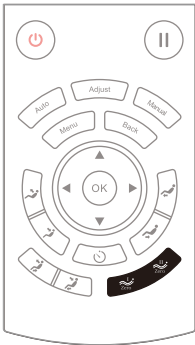

Button	Description
	Zero Gravity I: Adjust to the angle for Zero Gravity I.
	Zero Gravity II: Adjust to the angle for Zero Gravity II.

12.Back button

· During adjustment of any massage function, if you want to return to the main interface, you can press the back button to return to the running status information interface.

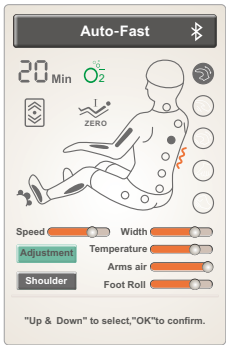
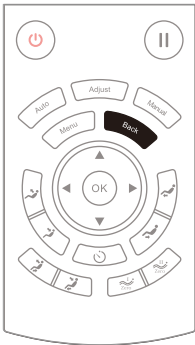

Method of Usage

13.Lying angle adjustment button

Button	Description
	Legrest up key: Hold down this key, and the legrest will rise slowly; release it, and the legrest will stop rising. After the leg upward movement is completed, the legrest will automatically detect the length of the feet.
	Legrest down key: Hold down this key, and the legrest will move downward slowly; release it, and the legrest will stop downward movement. After the leg downward movement is completed, the legrest will automatically detect the length of the feet.
	Backrest up button: Hold down the button to make the backrest rise slowly. Release it to stop such action.
	Backrest down button: Hold down the button to make the backrest move downward slowly. Release it to stop such action.
	Linkage sitting key: By holding down this key, the backrest will rise slowly and the legrest will move downward slowly; by releasing it, such UP/DOWN action of the backrest and the legrest will be stopped. After linkage sitting is completed, the legrest will automatically detect the length of the feet.
	Linkage lying key: By holding down this key, the backrest will move downward slowly and the legrest will rise slowly; by releasing it, such DOWN/UP action of the backrest and the legrest will be stopped. After linkage lying is completed, the legrest will automatically detect the length of the feet.
	Zero Gravity I key: Automatically adjust the legrest and the backrest to the position for Zero Gravity I.
	Zero Gravity II key: Automatically adjust the legrest and the backrest to the position for Zero Gravity II.
	Timing button: This button is used for time adjustment. After it is pressed every time, the duration will increase by 5 minutes. The total duration cannot exceed 40 minutes; otherwise, such setting will return to the minimum time value.

Method of Usage

III. Introduction to Armrest Shortcut Keys

Left armrest

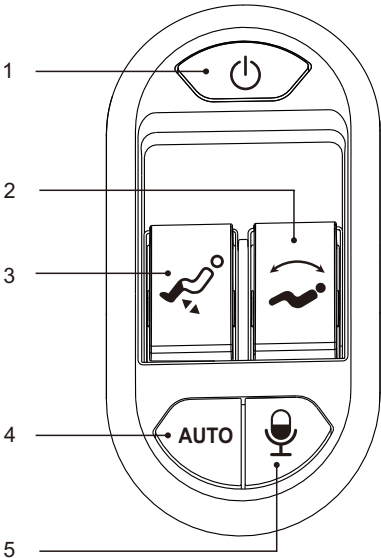

Right armrest

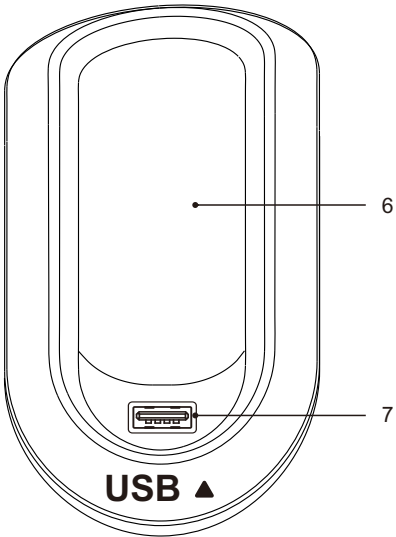

Introduction to the left armrest shortcut keys

- 1.Power "on/off "button: start or stop massage chair
- 2.Backrest and footrest lifting & lying button: for adjust the angle of the chair .
- 3.Footrest lifting& lying button: for adjust the angle of the footrest.
- 4.Auto : start Auto program
- 5.Voice control wake up button: press shortly to wake up the chair, press 3 seconds close or re-start of voice control function

Right hand pocket

- 6.Pocket : for remote controller and mobile phone
- 7.USB charge : Recharging mobile phone

Method of Usage

IV. Voice Control Instruction

- When the massage chair is turned on or in standby mode, the sound "Hi Alice" or "Hey Alice"will be produced to enable the voice control function. Alternatively, you can press the voice control button on the right armrest to enable the voice control function.
- Long press 3 seconds to turn on or off the voice control function.
- After such function is enabled successfully, the massage chair will reply "I am here." At this moment, once a corresponding voice control entry to be implemented is given within six seconds, the corresponding voice control function can be performed after a reply is received from the massage chair; if no correct voice control entry is given within six seconds, the voice control function automatically will be off automatically and needs to be enabled again.
- Note: When waking up the voice control function, please use English, the speech rate is moderate, Voice commands should be follow up the Voice entry.

Voice Control Entry		
Entry: "Hi Alice" or "Hey Alice". Answer: I am here.		
No.	Voice control entry	Answer entry
1	Massage on	Answer: Ok, massage on
2	Massage close	Answer: Ok, massage close
3	Comfort Massage	Answer: Ok, comfort massage
4	Relax massage	Answer: Ok, relax massage
5	Full body massage	Answer: Ok, full body massage
6	Neck and shoulder massage	Answer: Ok, neck and shoulder massage
7	Back and waist massage	Answer: Ok, back and waist massage
8	Stretch massage	Answer: Ok, stretch massage
9	Open the air pressure	Answer: Ok, open the air pressure
10	Close the air pressure	Answer: Ok, close the air pressure
11	Up the seat position	Answer: Ok, up the seat position
12	Down the seat position	Answer: Ok, down the seat position
13	Change the other mode	Answer: Ok, change the other mode
14	Go little down	Answer: Ok, go little down
15	Go little up	Answer: Ok, go little up

Note: commands 14 and 15 can only be used after command 13.

Method of Usage

V. Turn off the Power and Stop Massage

- If the power button is pressed during massage, all the massage functions will be turned off immediately, and the backrest and the footrest will go back to their default positions. If the massage time is up, all the massage functions will be turned off immediately, but the backrest and the footrest will not go back to their default positions.
- Shut off the power supply of this product as shown in the attached figure (Power Shut-off Diagram of the Product).

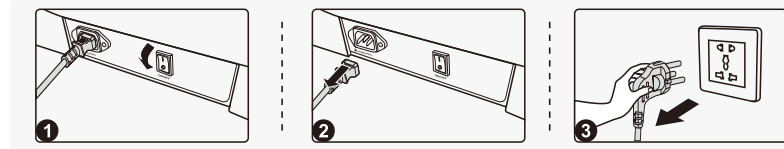

- 1 Power Shut-off Diagram of the Product
- 2 Disconnection Diagram
- 3 Unplugging Diagram

VI. Operation Instructions for Bluetooth Speaker Play

1. Enter the smart device main menu. Open "Settings" and select the "Bluetooth" option. Open "Bluetooth", and Bluetooth will automatically "Search for a New Bluetooth Device".
2. The smart device will search for the corresponding Bluetooth model (e.g. IMCM-XXXX). Click the "Match" button. If you are asked whether to match with the device, you just select "Match" to complete matching.
3. Turn on "Music Player" in the smart device and select the song to play.

VII. Installation Instructions for Legrest

- After connecting the wires and the air hose between the legrest and the massage chair, remove the cable ties and insert the connecting part into the seat (Figure 1).
- Place the round tubes on the left and right sides of the legrest onto the legrest support (Figure 2).

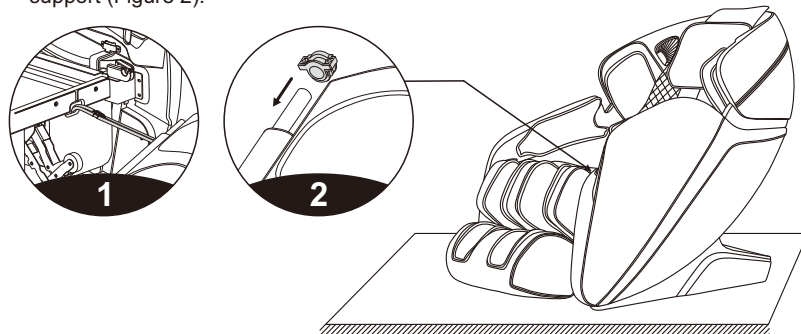

Method of Usage

- Next, turn the legrest fixing cover over to cover the round tubes on both sides of the legrest (Figure 3).
- Fasten the legrest to the massage chair with two M4 screws (one on each side). Check whether there is any abnormality during turning up and down, or any tube, cable or wire is folded. If everything is OK, the legrest is installed (Figure 4).

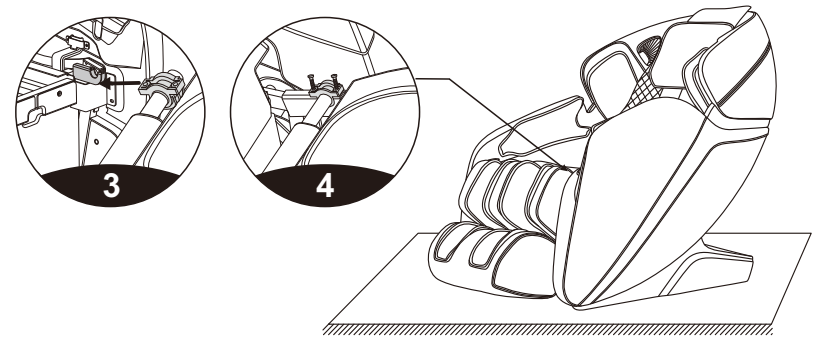

VIII. Instructions for Removal and Use of Head Cushion and Backrest

- The use of the head cushion can reduce the intensity of kneading massage on the neck and shoulders. You can decide whether to use the head cushion according to your own needs (the head cushion is recommended). The backrest and the back cushion are connected by a zipper (1). The head cushion and the backrest are connected by a hook-and-loop fastener (2).

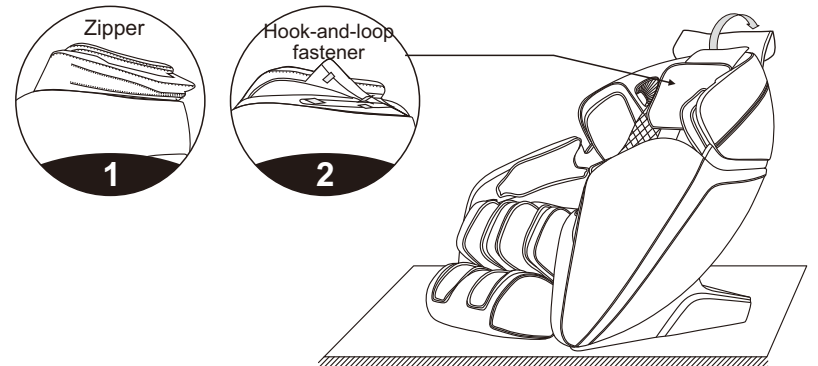

Method of Usage

IX. Floor Protection

- The prolonged heavy pressure on the massage chair may cause scratches on the floor. Thus, put a carpet or cushion on the floor where the massage chair is placed to avoid this damage.

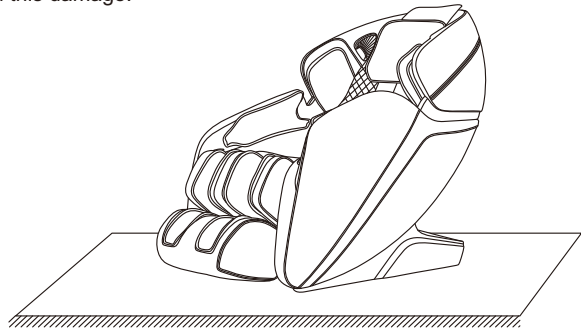

Note: Do not move the massage chair with its wheels on the rough ground or in a narrow space. At least two persons are required to lift it. During lifting, take the legrest sealing plate and backrest cover grooves as the acting points. (Do not lift the armrest directly.)

X. Instruction for Movement

- Make sure that all the wires are pulled away from the massage chair surface; then press the backrest down to a certain angle (with the center of gravity resting on the wheels), you can push the massage chair forward with hands, move it to a suitable position and gently restore it to the normal angle. (Note: During movement, you must turn off the power button first and then unplug the power cord and the remote controller connection wire).

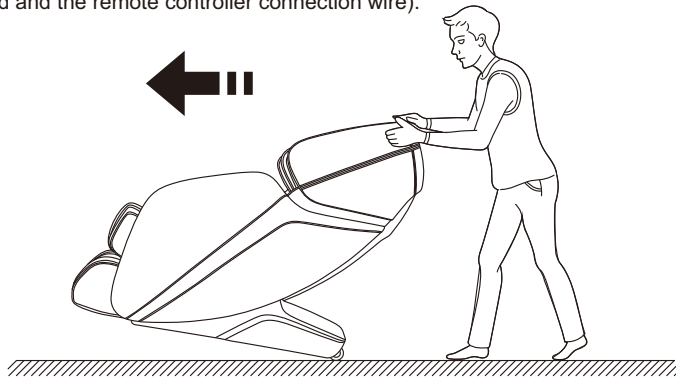

Warning : The rear moving wheels of the massage chair are only suitable for short-distance and slow movement. For long-distance transportation, please use other auxiliary moving tools to move this massage chair!

Product Specification

Model: iComfort Plus
Name: Massage Chair
Rated voltage: 110-120V~ 60Hz ☐
220-240V~ 50Hz/60Hz ☐
Rated power: 150W
Rated time: 20min
Safety structure: Class I

Material description: PVC, PA, steel parts, electric and electron components

MATERIAL	PU	LEATHER	CLOTH	WOOD